

MALIBU GENIUS:

IN A CLASS OF ITS OWN: THE MOTORHOME VAN



PRICE LIST 26.1 EN

VALID FROM 01/08/2025

malibu
a company of carthago



TABLE OF CONTENTS

Malibu genius

Legal and technical tips for choosing your motorhome	4-9
Highlights of the new Malibu Genius	10-11
Prices and technical data	12
Standard equipment	13-16
Equipment packages	17-19
Malibu genius performance 4x4	20
Additional standard equipment	21
Special equipment	22-23
Footnotes	24-25



IMPORTANT LEGAL AND TECHNICAL INFORMATION FOR THE SELECTION AND CONFIGURATION OF YOUR MOTORHOME

Each motorhome is only approved for a certain maximum weight on the road, which must not be exceeded under any circumstances when driving. When you select and configure your motorhome or van (hereinafter referred to as: “motorhome”), the technical and legal limits for the weight of the motorhome are therefore extremely important. These play a decisive part in the configuration, particularly when the additional equipment is being selected (equipment packages, special equipment and options).

The technical and legal requirements for the weight of your motorhome are regulated in EU Implementing Regulation No. 2021/535 (until June 2022: EU Implementing Regulation No. 1230/2012). This applies uniformly within the European Union. In order to make it easier for you to select and configure your motorhome in compliance with the legal and technical requirements, we will explain the key terms and requirements of this regulation and give you some information that is extremely important for configuring your vehicle and selecting your additional equipment (equipment packages, special equipment and options) from the items that are available from the factory. Please read this information carefully before configuring and ordering your vehicle. Our dealers will provide you with additional assistance in selecting and configuring your motorhome.

1. TECHNICALLY PERMISSIBLE GROSS VEHICLE WEIGHT

The technically permissible gross vehicle weight describes the maximum permissible weight, based on the layout, that your motorhome is allowed to weigh when laden (e.g. 3,500 kg, 4,500 kg) as specified by the manufacturer. This is entered in Part I of the registration certificate. You can find information about the technically permissible gross vehicle weight for each layout in the technical data which is shown in our sales documents (e.g. in the price lists).

Illustration in the price list:

PRICES AND TECHNICAL DATA	
	
Malibu genius 641 LE	
Chassis	Mercedes-Benz Sprinter 315 CDI
Base engine	Diesel 2.0 l (150 HP / 110 kW)
Length / width / height (mm)	6,403 / 2,020 / 2,685
Wheel base (mm)	3,665
Headroom in living area (mm)	1,900
Technically permissible gross vehicle weight (kg) ⁵²⁾	3,500 / 4,100**
Mass in running order (kg) ⁷⁾	2,984 (2,835 – 3,133)
Weight of additional equipment in series production specified by the manufacturer (kg) ⁵¹⁾	153
Max. towing capacity (kg) ⁵⁴⁾	2
Max. number of seats with 3-point safety belt while driving ⁵⁰⁾	4

The technically permissible gross vehicle weight (e.g. 3,500 kg) must not be exceeded under any circumstances while driving. If the vehicle exceeds the technically permissible gross vehicle weight while driving, this constitutes a regulatory offence which may be punishable with a fine. We therefore urgently advise you to check this before each journey and ensure that you and your vehicle do not exceed the technically permissible gross vehicle weight (e.g. 3,500 kg).

.....2nd MASS IN RUNNING ORDER

The weight in roadworthy condition corresponds to the (unladen) weight of the vehicle with standard factory equipment (including lubricants, tools, tyre repair kit and a fuel tank that is 90% full) plus a statutory default weight of 75 kg for the driver.

The mass in running order essentially includes the following items:

- the unladen weight of the vehicle with the main cabin including filled operating fluids such as lubricating grease, oils and coolants;
- the standard equipment, i.e. all equipment items which are included in the vehicle within the scope of delivery;
- a fresh water tank that is 100% full when driving (filling when driving in accordance with the manufacturer's specifications. You will find the manufacturer's information about filling the vehicle in the sales documents (e.g. in the price lists). This is 20 l or 50 l depending on the model range and an aluminium gas bottle that is 100% full, weighing 16 kg;
- a fuel tank that is 90% full;
- the driver, whose weight is set at a flat rate of 75 kg, regardless of the driver's actual weight.

The mass in running order is therefore the basic configuration of the vehicle model you have selected with standard equipment plus a statutory flat rate weight of 75 kg for the driver. This changes after selecting additional equipment (equipment packages, special equipment, options).

You will find information about the mass in running order for each layout in our sales documents (e.g. in the price lists).

It is important that the value given in our sales documents for the mass in running order is a standard value which is determined during the type approval procedure and checked by the authorities. It is legally permissible and possible for the mass in running order of the vehicle which is delivered to you to differ from the nominal value specified in the sales documents due to production-related tolerances. The legal tolerance is $\pm 5\%$. The EU legislator has taken into account the fact that there are certain fluctuations in the mass in running order due to fluctuations in the weight of the supplied parts as well as process and weather-related factors. Please take this into consideration when selecting and configuring your motorhome.

Example calculation illustrating these (permissible) production-related weight deviations:

Mass in running order according to sales documents:	2,900 kg
Legal tolerance of $\pm 5\%$:	145 kg
Legally permissible range of mass in running order:	2,755 to 3,045 kg

The specific range of permissible weight deviations for the mass in running order for each layout can be found in the technical data shown in our sales documents. As a manufacturer, we endeavour to restrict weight fluctuations to the minimum that is unavoidable in terms of production technology. Deviations above and below within the legally permissible tolerance range therefore only occur very rarely. However, in spite of constant technical optimisation of the production process, these cannot be completely avoided.

In order to ensure that all of the vehicles which are actually delivered comply with the legally permissible tolerance, the actual weight of the vehicle and compliance with the permissible tolerance of $\pm 5\%$ is checked by us as the manufacturer by weighing the vehicle upon completion in the production area at the end of the production line. Your dealer will inform you of the actual weight of your vehicle that was measured at the end of the production line. This gives you full transparency about any weight discrepancies that may be present in your vehicle.

.....3rd MAXIMUM NUMBER OF SEATS PERMITTED / WEIGHT OF PASSENGERS

The maximum number of permitted seats while driving is determined by us as the manufacturer during the type approval procedure. The weight of the passengers results from the maximum number of permitted seats. The weight of the passengers is a flat rate of 75 kg for each approved seat which we as the manufacturer have provided for the vehicle, regardless of what the passengers actually weigh. This is also a legally prescribed calculation. Since the weight of the driver is already included in the mass in running order, i.e. 75 kg (see section 2.), this is not taken into consideration in the weight of the passengers. In a motorhome with four approved seats, the weight of the passengers is $3 \times 75 \text{ kg} = 225 \text{ kg}$.

The specification of the maximum permissible number of seats in the sales documents refers to the respective vehicle weight in a standard set-up without additional equipment (for additional equipment, see section 4.) and specifies the maximum possible number of persons who can be seated while driving.

However, the number of seats depends on the weight and axle load. For example, it can be reduced by installing additional equipment (e.g. by selecting equipment packages, special equipment and options) or, depending on the model, only be achieved by increasing the permissible total weight and/or by omitting additional equipment.

4th ACTUAL WEIGHT AND ADDITIONAL EQUIPMENT

The mass in running order (see section 2.) and the weight of the factory-installed additional equipment (equipment packages, special equipment, options) in a specific vehicle are collectively referred to as the actual weight of the vehicle.

You can find information about the actual weight of your vehicle after it has been handed over in section 13.2 of the Certificate of Conformity (CoC), which will be given to you by your dealer when the handover takes place.

Please note that the actual weight which is specified in the Certificate of Conformity (CoC) is also a standard value. Since the mass in running order – as part of the actual weight – has a legally permissible tolerance of $\pm 5\%$ (see section 2.), the actual weight can deviate from the specified nominal value accordingly.

According to the legal definition, the so-called additional equipment includes all optional equipment parts that are not included in the standard equipment and is fitted to the vehicle by the manufacturer (i.e. ex works) and can be ordered by the customer (e.g. awning, bicycle or motorcycle rack, satellite system, solar energy system, oven etc.). Information about the individual or package weights of the equipment packages, special equipment and options which can be ordered can be found in our sales documents. Other accessories that are retrofitted after delivery of the vehicle from the factory by the dealer or by you personally are not included in the special equipment in this sense.

.....5th MANUFACTURER'S SPECIFIED MAXIMUM WEIGHT
FOR ADDITIONAL EQUIPMENT AND PAYLOAD

Since the installation of additional equipment is also subject to legal and technical limits, we determine the value of the maximum weight of additional equipment which can be fitted to the vehicle in addition to the standard equipment (e.g. by selecting equipment packages and/or special equipment) for each layout and vehicle. This value must not be exceeded when you are selecting and configuring your vehicle.

The weight of additional equipment specified by the manufacturer can be found in our sales documents (e.g. in the price lists).

PRICES AND TECHNICAL DATA	
	
Malibu genius 641 LE	
Chassis	Mercedes-Benz Sprinter 315 CDI
Base engine	Diesel 2.0 l (150 HP / 110 kW)
Length / width / height (mm)	6,403 / 2,020 / 2,685
Wheel base (mm)	3,665
Headroom in living area (mm)	1,900
Technically permissible gross vehicle weight (kg) ⁵²⁾	3,500 / 4,100**
Mass in running order (kg) ⁷⁾	2,984 (2,835 – 3,133)
Weight of additional equipment in series production specified by the manufacturer (kg) ⁵³⁾	153
Max. towing capacity (kg) ⁵⁴⁾	2
Max. number of seats with 3-point safety belt while driving ⁵⁵⁾	4

The maximum weight of additional equipment specified by the manufacturer is intended to ensure that the legally prescribed minimum payload is also actually available for the vehicle payload after delivery of a vehicle by the manufacturer. This means that only a certain amount of additional equipment can be ordered and installed in the factory, in order to leave a sufficient weight allowance available for luggage and other accessories (the so-called payload) without exceeding the technically permissible gross vehicle weight.

The payload is calculated by subtracting the mass in running order (nominal value according to the sales documents, see section 2.), the weight of passengers (see section 3.) and the maximum weight of additional equipment specified by the manufacturer from the technically permissible gross vehicle weight (see section 1).

For motorhomes, the European legislation prescribes a fixed minimum payload, which must remain for luggage or other accessories which are not installed in the factory. This minimum payload is calculated as follows:

Minimum payload in kg $\geq 10 \cdot (n + L)$
In this calculation: 'n' = maximum number of passengers plus the driver and 'L' = total length of vehicle in metres (including decimal places).
For a motorhome with a length of 7 m and 4 approved seats (including the driver), for example, the minimum payload is 10 kg $\cdot (4 + 7) = 110$ kg.

When you are configuring your motorhome, please note that the payload must not fall below the minimum.

To ensure that the minimum payload is adhered to, there is a maximum combination of additional equipment which can be ordered for each vehicle model. In the above-mentioned example with a minimum payload of 110 kg, the total weight of additional equipment for a vehicle with four approved seats (including the driver) and a mass in running order of 2,900 kg should be a maximum of 265 kg:

3,500 kg	Technically permissible gross vehicle weight
- 2,900 kg	Mass in running order
- 3 x 75 kg	Weight of passengers
- 110 kg	Minimum payload
= 265 kg	Additional equipment

Please note that this calculation is based on the standard value for the mass in running order determined during the type approval process, without taking account of the permissible weight deviations for the mass in running order (see section 2.). If the maximum permissible value for the additional equipment of (in this example) 265 kg is almost or completely exhausted, an upward weight deviation in the mass in running order may therefore result in the minimum payload of 110 kg being theoretically maintained using the standard value of the weight in running order, but in reality there is no corresponding payload option.

Here is another sample calculation for a vehicle with four approved seats, whose actual mass in running order is 1% above the nominal value:

3,500 kg	Technically permissible gross vehicle weight
- 2,929 kg	Actual mass in running order of the vehicle (+ 1% compared to the 2,900 kg specified in the sales documents)
- 3 x 75 kg	Weight of passengers
-265 kg	Weight of additional equipment
= 81 kg	Actual payload (< minimum payload of 110 kg); in this example, the minimum payload is therefore undershot by 29 kg

In order to avoid such a shortfall in the minimum payload, the manufacturer reduces the weight of the additional equipment that can be ordered based on the layout. Limiting the additional equipment is intended to ensure that the minimum payload, i.e. the legally prescribed weight available for luggage and other accessories, is actually achieved for the payload of the vehicles delivered by the manufacturer.

As, due to production reasons, the actual weight of the specific vehicle is only determined when it is weighed at the end of the production line, it cannot be completely ruled out that in rare exceptional cases a situation may arise, whereby the minimum payload is not guaranteed at the end of the production line despite this limitation of additional equipment. In order to guarantee the minimum payload in these cases, the manufacturer will check with you and your dealer before delivery of the vehicle whether, for example, the vehicle is overloaded, the number of permitted seats is reduced or additional equipment is omitted to reduce the weight, so that you receive a vehicle that has the legal minimum payload. The weight of additional equipment offered by the manufacturer can be found in our sales documents (e.g. in the price lists).

Illustration in the price list:

Article no.		£ incl. 20 % VAT	kg
Mercedes-Benz Sprinter chassis			
310614	93-litre fuel tank	400	20
310007	Weight variant 4,100 kg ²⁸⁾	1,46	10
330402	Load decrease from 4,100 kg to 3,500 kg	295	-
331612	High-performance LED headlights	2,2	2
331613	Fog lights with cornering lights	345	-
310503	Heated windscreen	500	-
410975	Electric closing aid for sliding door	425	5
310684	Removable tow bar ^{3) 54)}	1,165	32
311440	Frame extension (preparation for tow bar)	190	26
330071	Heated seats and lumbar support (driver's side/passenger side (LHD)) incl. wet wiper system ⁴⁹⁾	685	2
310800	Four-wheel drive incl. rear lights in LED technology ⁵⁷⁾	6,025	150

The additional weight of additional equipment (all equipment parts not included in the standard equipment) increases the actual weight of the vehicle (= mass in running order plus the selected additional equipment) and reduces the payload. The specified value indicates the additional weight compared to the standard equipment of the respective layout. The total weight of the selected additional equipment (equipment packages, special equipment and options) must not exceed the maximum weight of additional equipment specified by the manufacturer.

6. HOW TOLERANCES IN THE WEIGHT IN ROADWORTHY
CONDITION AFFECT THE PAYLOAD

Regardless of the minimum payload, you should also note that unavoidable production-related fluctuations in the mass in running order have an effect on the remaining payload:

If you order our example vehicle (see section 5) with additional equipment with a total weight of 150 kg, the calculated payload is 225 kg based on the default value for the weight in roadworthy condition. Due to the tolerances, the payload that is actually available may deviate from this value and may be higher or lower. If the mass in running order of your vehicle is about 1% higher than the weight specified in the sales documents, the possible payload is reduced from 225 kg to 196 kg:

3,500 kg	Technically permissible gross vehicle weight
- 2,929 kg	Actual mass in running order of the vehicle (+ 1% compared to the 2,900 kg specified in the sales documents)
- 3 x 75 kg	Weight of passengers
- 150 kg	Ordered additional equipment for the specifically configured vehicle
= 196 kg	Actual payload

To ensure that the calculated payload is actually achieved, you should therefore take into account the possible and permissible tolerances in the mass in running order when selecting and configuring your vehicle. We also strongly recommend weighing the laden motorhome on a non-automatic weighbridge before every journey and determining whether the technically permissible total vehicle weight and the technically permissible total axle load are adhered to, taking account of the individual weight of passengers.



You can find
more information
online!

THE MOTORHOME VAN: THE **MALIBU GENIUS**

THINKING BEYOND THE LIMITS OF WHAT IS POSSIBLE.

When short is too short and long is too long, the Malibu genius on a Mercedes-Benz Sprinter chassis is just right thanks to our innovative rear extension. This has allowed us to achieve **a compact vehicle length of 6.41 m with a unique layout design** that maximises living, sleeping and driving comfort.

A cut above the rest: The motorhome van. Why? The Malibu Genius combines the best of both worlds. It marries the benefits of a compact camper van with the genes and body technology of a spacious motorhome.



COMPACT VEHICLE LENGTH THANKS TO INNOVATIVE REAR EXTENSION WITH UP TO 1,400 L STORAGE-SPACE CAPACITY.

Thanks to our innovative rear extension, we have increased the length of the Mercedes-Benz Sprinter from 5.93 to 6.41 metres. This results in a unique vehicle concept with an abundance of storage space totalling 1,400 litres in volume.

MAXIMUM SLEEPING COMFORT WITH COMFY LENGTHWAYS SINGLE BEDS.

Unique on a Mercedes-Benz Sprinter chassis: Thanks to the rear extension, travellers can enjoy maximum sleeping comfort in the two fold-up lengthways single beds with a length of up to two metres.





COMFORTABLE SUPERMAX BATHROOM WITH INNOVATIVE SHOWER ROOM EXTENSION.

More space in a compact size: The Malibu Genius boasts the most comfortable washroom in its class. Thanks to the swivel-away toilet, it provides loads of room to move. Thanks to the innovative shower room extension that extends into the living area, you get a huge shower cubicle with all the space you need.



KITCHEN HIGHLIGHTS.

Extra-long kitchen unit with two-ring gas hob with electric ignition and practical glass cover, three deep, roller-mounted kitchen drawers with double locking mechanism and soft-close mechanism, multifunctional, flush-mounted sink cover including chopping board. The kitchen is complemented by a flush, fold-up worktop extension with one-hand operation in the entrance area.



2-ROOM CONCEPT.

The dressing room in the Malibu Genius provides a private area with loads of space: When the bathroom door is swung towards the front, it acts as a partition to provide a private space for passengers.

LARGE LOUNGE SEATING AREA.

Thanks to the rotating driver's cab seats, the Malibu Genius provides a large and comfortable lounge seating area with plenty of room for four people. Despite this, there is still ample passage width in the living area.



DISCOVER MORE ABOUT THE NEW MALIBU GENIUS

www.malibu-carthago.com

PRICES AND TECHNICAL DATA

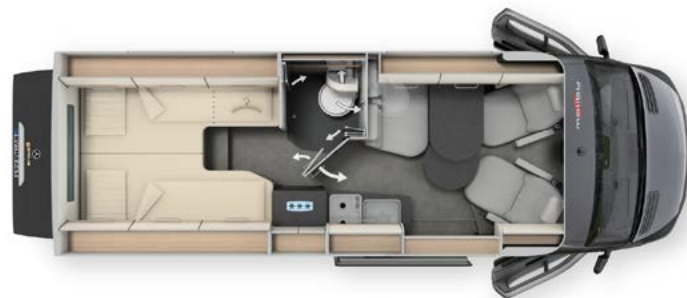



	Malibu Genius 641 LE
Chassis	Mercedes-Benz Sprinter 315 CDI
Base engine	Diesel 2.0 l (150 HP / 110 kW)
Length / width / height (mm)	6,403 / 2,020 / 2,685
Wheel base (mm)	3,665
Headroom in living area (mm)	1,900
Technically permissible gross vehicle weight (kg) ⁵²⁾	3,500 / 4,100**
Mass in running order (kg) ⁷⁾	2,984 (2,835 – 3,133)
Weight of additional equipment in series production specified by the manufacturer (kg) ⁵¹⁾	153
Max. towing capacity (kg) ⁵⁴⁾	2,000
Max. number of seats with 3-point safety belt while driving ⁵⁰⁾	4
Rear bed dimensions (mm)	2,030 x 930 / 1,960 x 850
Seating area bed conversion dimensions (mm) **	1,600 x 1,145
Bed access height (mm)	990
Refrigerator volume / freezer compartment (l)	84 / 6
Heating system	Truma Combi 4
Fresh water tank volume (l) ¹⁸⁾	100
Fresh water tank volume when filled for driving (l)	20
Waste water tank volume (l)	90
Battery capacity (Ah)	90 lithium
230 V / 12 V / USB sockets	3 / 1 / 1
Article no.	161641



* List price ex works including registration documents



** In conjunction with special equipment

STANDARD EQUIPMENT

		641 LE
	Chassis Mercedes Benz Sprinter 315 CDI Standard	
	Engine: 2.0 l diesel with Adblue (22 l), 150 HP / 110 kW, 4 cylinders, 330 Nm, Euro VI E, 6-speed transmission, rear-wheel drive	X
	Front axle with increased load bearing capacity	X
	High roof	X
	Start / Stop system	X
	Keyless start incl. Start/Stop button	X
	Driver / passenger airbag ⁹⁾	X
	Side Wind Assist, Hill Descent Control, ABS, ASR, EBV, ESP	X
	Rain sensor	X
	Active Brake Assist and Driver Drowsiness Detection	X
	Insulated engine compartment for noise reduction	X
	Mercedes-Benz original comfort seats, rotatable	X
	Steering wheel with adjustable angle and height	X
	Driver's and passenger's cup holder	X
	Shelf above windscreen	X
	Heat-insulating glass all around	X
	Electric hot-air auxiliary heating	X
	Automatic driving light control	X
	Mercedes-Benz emergency call system, breakdown management	X
	Fleece battery 12 V / 92 Ah	X
	71-litre fuel tank	X
	16-inch steel wheels	X
	All-weather tyres (M+S)	X
	Daytime running lights integrated in headlights	X
	Central locking	X
	Electrically adjustable and heated exterior rear view mirrors	X
	Seat belt warning system for driver's and passenger's seat	X
	Entrance handle in entrance area	X

		641 LE
	Habitation	
6-year water ingress warranty		X
Exterior colour: Camper White		X
Fully insulated floor panel and roof insulation with RTM hard foam		X
Side walls and body frame members lined with polyurethane insulating foam mats to prevent thermal bridging		X
Two Dometic S7P aluminium framed windows in living area with insect screen blind and pleated blackout blind		X
Dometic S7P aluminium framed window in washroom		X
Dometic S7P aluminium framed window in sleeping area on driver's side (LHD) with insect screen roller blind and pleated blackout blind		X
Dometic S7P aluminium framed window in rear wall		X
Extra-wide, extending electric entrance step with warning buzzer		X
Entrance light/reading light on passenger side (LHD)		X
Large, extra-low rear garage with ergonomic access via huge rear hatch		X
Innovative rear extension in GRP sandwich construction. Best insulation values (extra protect), no cold bridges		X
	Cab	
Driver's and passenger's comfort seats with arm rests adjustable on both sides, with tilt adjustment, seats 180° rotatable		X
Unique feeling of space thanks to increased interior height in cab above lounge seating area		X
	Interior design	
"Cherry Style Plus" style range: Furniture surfaces in a bicolour appearance with Fine Cherry finish and high-gloss ivory fronts. Grey trims in kitchen		X
	Living area	
Living area seat upholstery with multi-layer premium foam core		X
ISOFIX preparation in lounge seating area (1 seat)		X
Two designer shelves above lounge seating area		X
Living area table with swivel-out tabletop extension		X
Skylight (70 x 50 cm) above lounge seating area		X
Double connection technology: Furniture parts screwed together and mortised		X
Prop struts, hinges, pull-outs in metal		X
"Ergo" strip handles on furniture doors, easy to use with secure locking mechanism		X
Ceiling canopy in living area with indirect LED ambient lighting		X

		641 LE
	Storage space	
Double floor storage compartment under lounge seating area with large bilge hatch and high-quality hinges		X
Large storage drawer under bench seat, easy to access from front and above		X
Universal cupboard with two large drawers under the lengthways single bed on the passenger side (LHD), can be used as needed for extra kitchen storage or linen storage		X
Wardrobe		
Large, extra-high wardrobe under lengthways single bed on driver's side (LHD) (easily accessible from above and from the front), with large linen drawer behind		X
Rear storage space / overhead storage cabinets		
Rear beds fold up to allow use of rear storage space		X
Three large overhead storage cabinets on both sides with open corner shelves in rear		X
Additional shelf below overhead storage cabinets on driver's and passenger's sides		X
Additional storage compartments under rear beds		X
Additional cupboard with two large drawers under the lengthways single bed on the passenger side (LHD), easily removable when transporting pedelegs or very tall objects		X
Bed height adjustable by 50 mm for maximum use of space when transporting very tall pedelegs or bulky objects		X
	Kitchen	
Worktop with robust, slate-effect finish		X
Two-ring gas hob with glass cover, stainless steel design, electric igniter		X
Stainless steel sink flush-mounted in work surface		X
Tall metal mixer tap with ceramic seal		X
Extra-wide kitchen drawers with double locking, roller-mounted and soft-close mechanism		X
Integrated wooden cutlery tray		X
Integrated, pull-out waste bin in universal cabinet		X
Refrigerator		
84-litre compressor refrigerator (incl. 6-litre freezer compartment) integrated in universal combination cabinet, additional battery option recommended.		X
	Bathroom Dressing room	
Dressing room		
Dressing room with partition door with swivel function to divide off living area and dressing room		X
Supermax bathroom		
One-level floor with flush-mounted shower entrance thanks to shower floor inlay, additional room to move when sectional shower door is open in dressing room in front of kitchen unit		X
Swivel-away toilet and large, fold-away washbasin, room extension for washing, showering or toilet function		X
Huge shower cubicle that extends into living area thanks to innovative shower room extension incl. new, sectional shower doors		X
Large mirror cabinet above washbasin, with loads of storage spaces		X
Micro Heki skylight		X
Dometic S7P aluminium framed window in washroom		X

		641 LE
	Sleeping	
Two-part rear beds, ventilated slatted frame across entire vehicle width		X
Easy bed access via convenient, multifunctional bed access steps, can be pulled out with your foot thanks to handy sliding mechanism		X
Mini Heki skylight above rear bed		X
Interior window trim with microfibre cover for side and rear window		X
Ambient lighting in rear		X
	Services	
Water		
Frost-proof, easy-to-access water drainage taps		X
Water supply via submersible pump system		X
Gas		
Gas compartment in rear storage space accessible from front (2 x 11 kg)		X
Main gas taps in kitchen area		X
Electrical system		
Electrical centre under lounge bench seat		X
230 V sockets in kitchen, bathroom and entrance area		X
12 V socket in cab		X
Double USB socket in cab		X
230 V external electricity supply via external socket		X
18 A automatic charger, electronic control, automatic cut-off when voltage too low, incl. starter battery charging function		X
Multifunctional panel above habitation door		X
90 Ah lithium-ion battery, incl. battery computer		X
Living area lighting		
Numerous LED spotlights across entire living area		X
Indirect accent lighting in entrance area		X
Work light and ambient lighting can be switched on separately		X

EQUIPMENT PACKAGE

Article no.	216206	
Chassis package	Weight	
	kg	£
Wheel trims		70
Tempmatik semi-automatic air-conditioning system		2,625
Electric handbrake		495
Cruise control		470
Instrument cluster with colour display		495
Leather steering wheel with multifunctional buttons option (incl. leather gear stick for manual transmission)		390
Digital reversing camera		950
MBUX 10,2" multimedia system incl. sat nav and DAB ⁶⁵⁾		3,870
Traffic sign assist		375
Audio package		165
Hinged lid for storage compartment		165
Jet air vent on dashboard		125
Charge booster ¹²⁾		185
Cab blind system on windscreen and side windows ⁸⁾		640
Heat-insulating glass on windscreen		295
Wiring for radio with roof aerial and DAB+, speakers (4x) ³⁴⁾		475
Cab comfort seats with tilt and height adjustment (front / rear)		500
Cab comfort seats covered in the same material as the living area including padded armrests		665
Pre-wiring for tow bar including tow socket		315
Electric folding wing mirrors		105
Total price of individual options		13,375
Package price	53.5	5,615
Your savings		7,760

Article no.

216203

Habitation package	Weight	
	kg	£
Microfibre, climate-regulating headliner		400
Kitchen upgrade (worktop extension, divided sink cover with chopping board function, fronts in matt ivory)		210
High-quality cold foam mattress on rear bed		305
Truma CP Plus		90
Insulated fresh and waste water tank, fresh water tank also heated		595
Insect screen behind sliding door		590
Total price of individual options		2,190
Package price	12	1,975
Your savings		215

Article no.

216279

Chassis Plus package*	Weight	
	kg	£
9G-TRONIC automatic transmission including hold function		3,010
Engine variant 170 HP / 125 kW, Euro VI E (only in conjunction with automatic transmission)		1,720
17-inch alloy wheels (silver) with summer tyres		1,340
THERMOTRONIC automatic air conditioning with rain sensor ¹³⁾		580
Ergonomic armrests for driver 's and passenger's seats		105
Total price of individual options		6,755
Package price	19.5	6,310
Your savings		445
SURCHARGE: Engine variant 190 HP / 140 kW, Euro VI E (only in conjunction with automatic transmission)	8	2,810

* Components of the package not available individually.

Article no.	216204	
Style package	Weight	
	kg	£
Body-coloured radiator grille frame		165
Chrome-plated radiator grille		340
Body-coloured front bumper		475
Total price of individual options		980
Package price	0	855
Your savings		125

Article no.	216207	
Driver's Assistance package* 8)	Weight	
	kg	£
DISTRONIC Active Distance Assist		710
Active Lane Departure Warning Assist		0
Headlight Assist		355
Tyre pressure monitoring system		55
Package price	0	1,095

* Only in conjunction with MBUX 10,2" multimedia system and 9-speed Tronic automatic transmission Active brake assistant and active driver drowsiness detection included as standard.

Article no.	216208	
Self-sufficiency package	Weight	
	kg	£
150 Ah lithium-ion battery including battery computer and separate touch display ⁶⁷⁾		1,905
Second 150 Ah lithium-ion battery, incl. battery computer		2,080
70 A charge booster		185
3x 18 A chargers (in addition to standard 18 A charger)		260
Voltage transformer for 12 V to 230 V, 1.800 watts, mains priority circuit		1,685
Package price	38	5,475
SURCHARGE: Solar energy system: 2 x 110 Watts	16.5	1,720

THE MALIBU GENIUS

PERFORMANCE 4X4 ALSO AVAILABLE

Explore the world in style and freedom! Our luxurious Malibu genius performance 4x4 combines exclusive comfort with complete self-sufficiency and maximum flexibility. Perfect for those who want to go their own way and travel in style. Enjoy the freedom to explore the world your way and make a statement – your adventure, your style, your freedom.

The permanent four-wheel drive provides you with perfect traction and stability at all times and on any type of terrain. Whether on wet roads, muddy pitches or snowy mountains, the genius performance 4x4 ensures a safe and superior driving experience. Whatever your next adventure, you'll always be ready.

PRICES AND TECHNICAL DATA	Malibu genius performance 4x4 641 LE
Chassis	Mercedes-Benz Sprinter 419 CDI
Base engine	Diesel 2.0 l (190 HP / 140 kW)
Transmission	9G-TRONIC automatic transmission
Drive system ⁵⁷⁾	All-wheel drive
Length / width / height (mm)	6,403 / 2,020 / 2,845
Wheel base (mm)	3,665
Headroom in living area (mm)	1,900
Technically permissible gross vehicle weight (kg) ⁵²⁾	4,100
Mass in running order (kg) ⁷⁾	3,099 (2,944 – 3,254)
Weight of additional equipment in series production specified by the manufacturer (kg) ⁶¹⁾	637
Max. number of seats with 3-point safety belt while driving	4 ⁵⁰⁾
Max. towing capacity (kg) ⁵⁴⁾	2,000
Rear bed dimensions (mm)	2,030 x 930 / 1,960 x 850
Seating area bed conversion dimensions (mm) **	1,590 x 1,150
Bed access height (mm)	990
Refrigerator volume / freezer compartment (l)	84 / 6
Heating system	Truma Combi 6 D+E
Fresh water tank volume (l)	100 ¹⁸⁾
Fresh water tank volume when filled for driving (l)	20
Waste water tank volume (l)	90
Battery capacity (Ah)	2 x 150 Ah lithium batteries
230 V / 12 V / USB sockets	3 / 1 / 1
Article no.	161642

* List price ex works including registration documents

** In conjunction with special equipment

MALIBU GENIUS PERFORMANCE 4X4 EXTRA STANDARD EQUIPMENT *

		641 LE
 Equipment packages		
Chassis package		X
Habitation package		X
Driver assistance package		X
Self-sufficiency package		X
Style package		X
 Mercedes-Benz Sprinter chassis		
Engine variant 170 HP / 140 kW, Euro VI E		X
Permanent four-wheel drive including LED rear lights ⁵⁷⁾		X
16-inch steel rims (black) with BF Goodrich all-terrain tyres (or equivalent ⁶¹⁾		X
9G-TRONIC automatic transmission including hold function		X
Weight variant 4,100 kg ²⁸⁾		X
93-litre fuel tank		X
THERMOTRONIC automatic air conditioning including rain sensor		X
High-performance LED headlights		X
 Main cabin and comfort		
Roof-mounted awning, length 325 cm		X
LED exterior lighting including rain gutter		X
Socket package: 3x USB sockets / 2x 230 V sockets ²⁴⁾		X
Truma Combi 6 D+E including altitude kit (operated by diesel/electricity) ²⁷⁾		X
Truma Duo Control CS with crash sensor and automatic changeover ¹⁹⁾		X
Malibu table and chair set including Malibu logo and carry bags ³²⁾		X
Premium tool kit		X
Additional heating of waste water tank and waste water pipes		X
Exterior colour: Obsidian Black Metallic, including painted rear extension		X
Additional "Performance 4x4" exterior decal		X
11-inch LED light bar		X

**EXTRA STANDARD
EQUIPMENT**

* Includes the same standard equipment as the genius (from page 13)
and the following additional standard equipment

DISCOVER MORE ABOUT THE NEW MALIBU GENIUS

www.malibu-carthago.com

SPECIAL EQUIPMENT FOR GENIUS AND GENIUS PERFORMANCE

Article no.		£ incl. 20 % VAT	kg	641 LE	performance 4x4 641 LE
Mercedes-Benz Sprinter chassis					
310614	93-litre fuel tank	400	20	○	X
310007	Weight variant 4,100 kg ²⁸⁾	1,460	10	○	X
330402	Load decrease from 4,100 kg to 3,500 kg	295	-	○	-
331612	High-performance LED headlights	2,200	2	○	X
331613	Fog lights with cornering lights	345	-	○	○
310503	Heated windscreen	500	-	○	○
410975	Electric closing aid for sliding door	425	5	○	○
310684	Removable tow bar ^{3) 54)}	1,165	32	○	○
311440	Frame extension (preparation for tow bar)	190	26	○	○
330071	Heated seats and lumbar support (driver's side/passenger side (LHD)) incl. wet wiper system ⁴⁹⁾	685	2	○	○
310800	Four-wheel drive incl. rear lights in LED technology ⁵⁷⁾	6,025	150	○	X
Compulsory options in conjunction with permanent four-wheel drive 4x4					
330310	16-inch steel rims (black) with BF Goodrich all-terrain tyres (or equivalent ⁶¹⁾)	1,820	19	○	X
310149	Engine variant 170 HP / 140 kW, Euro VI E	4,525	8	○	X
310402	9G-TRONIC automatic transmission including hold function	3,010	10	●	X
310614	93-litre fuel tank	400	20	○	X
210336	THERMOTRONIC automatic air conditioning including rain sensor	580	1	●	X
310007	Weight variant 4,100 kg	1,460	10	○	X
Habitation exterior					
410239	Exterior colour: Tenorite Grey Metallic, incl. painted rear extension	2,580	-	○	-
410240	Exterior colour: Obsidian Black Metallic, including painted rear extension	2,580	-	○	X
410238	Exterior colour: High-Tech Silver Metallic, incl. painted rear extension	2,580	-	○	-
410290	Special exterior graphic wave element	340	-	○	X
410522	Roof-mounted awning, length 325 cm	1,150	22.5	○	X
410691	LED exterior lighting including rain gutter	260	1	○	X
410413	Dometic S7P framed window on passenger side (LHD) in rear bed area ⁵³⁾	380	3.5	○	○
410810	Basic pull-out rails in rear garage (flush-mounted in floor) ⁶⁴⁾	340	12	○	○
410916	Pedelec and bike rack for tow bar, folding ⁶²⁾	750	20	○	○
410917	"Weekender" pedelec and bike rack pull-out system ^{56) 58)}	1,115	24	○	○
410830	Pull-out organisation system with transport boxes incl. extension rails ⁵⁸⁾	1,685	44	○	○

○ = special equipment X = standard equipment - = not possible ● = included in package

Article no.		£ incl. 20 % VAT	kg	641 LE	performance 4x4 641 LE
Electrical system					
510270	Socket package: 3 x USB sockets / 2 x 230 V sockets ²⁴⁾	425	5	○	X
510059	Second 90 Ah lithium-ion battery, incl. battery computer and additional 18 A charger	855	14	○	-
510140	Solar system pre-wiring	210	2	○	○
Gas Water Heating					
650146	Truma Combi 6 E (operated by gas/electricity) ²⁶⁾	770	2	○	-
650136	Truma Combi 6 D+E incl. height kit (operated by diesel/electricity) ²⁶⁾	1,285	1	○	X
650125	Truma Duo Control CS with crash sensor and automatic changeover ¹⁹⁾	380	3	○	X
610021	Gas filter for Truma Duo Control CS (recommended, only in conjunction with Truma Duo Control CS) ³⁶⁾	190	0.5	○	○
610355	Additional heating of waste water tank and waste water pipes	905	5	○	X
650262	1,700 W roof-mounted air-conditioning system	1,950	29	○	○
Radio Multimedia TV Satellite					
710527	24" smart LED TV with TV bracket incl. connector kit ²⁾	1,260	7	○	○
750160	Pre-wiring for satellite system	210	1	○	○
Interior					
810690	Conversion kit to convert seating area into a sleeping berth with additional cushion	400	14	○	○
810271	Cushion insert for lengthways single beds for extended sleeping area	250	4	○	○
810750	Malibu table and chair set, incl. Malibu logo and carry bags ³²⁾	280	12	○	X
810760	ISOFIX option for one seat ⁵⁵⁾	80	0.5	○	○
Living area materials Living environments					
850304	London 25 fabric combination	Standard	-	X	X
850324	Santorini/Antara fabric combination	Standard	-	X	X
850334	Lisbon 25 - Antara fabric combination	Standard	-	X	X
850314	Paris quilted upholstery combination	365	-	○	○
850640	Davos/faux leather fabric combination	365	1	○	○
850506	Platinum part leather	1,285	2	○	○
850502	Sleeping environments & soft furnishings set: Decorative cushions, bed throw, fitted sheet set ³⁵⁾	355	3.5	○	○

FOOTNOTES

- ²⁾ Smart TV with receiver and DVB-T2 tuner (USB- HDMI, full HD). TV position above lounge seating area on bathroom wall. Omission of designer shelves above lounge seating area if 24" smart LED TV option chosen.
- ³⁾ Considerably more difficult to retrofit
- ⁷⁾ In accordance with EU Implementing Regulation No. 2021/535, the mass in running order corresponds to the (unladen) weight of the vehicle with factory-installed standard equipment (including lubricants, tools, tyre repair kit) plus driver (75 kg), 90% full fuel tank, fresh water tank when driving (20 l), 100% full aluminium gas bottle. The weight specified by the manufacturer for additional equipment is basically dependent on the weight in roadworthy condition, and is reduced by installing additional equipment (equipment packages, special equipment). Please note that the actual weight which is specified in the Certificate of Conformity (CoC) is also a standard value. Since the mass in running order – as part of the actual weight – has a legally permissible tolerance of $\pm 5\%$, the actual weight can deviate from the specified nominal value accordingly. Detailed information can be found on page 5, no.2.
- ⁸⁾ When selecting the driver assistance package, there is a cut-out for the camera casing in the cab blind system where the camera is positioned (top centre).
- ⁹⁾ Child seats with restraint systems must not be installed on the passenger seat.
- ¹²⁾ The charge booster is incorporated between the alternator and the starter/habitation battery, ensuring that the alternator generates power during travel until the batteries are charged.
- ¹³⁾ In adverse conditions, manual readjustment of the air conditioning system may be necessary.
- ¹⁸⁾ The specified fresh water tank volume already includes the volume of the boiler.
- ¹⁹⁾ In the basic configuration when calculating the mass in running order, only "one" 100% full aluminium gas bottle at 16.5 kg is taken into consideration. The "DuoControl CS with crash sensor" option (automatic changeover and de-icing function) can in principle also be operated with one connected gas bottle. When connecting and using a second gas bottle, the remaining load capacity of your vehicle will be reduced by 16.5 kg if an aluminium gas bottle is used. Steel gas bottles are around 5 kg heavier.
- ²⁴⁾ Socket package option: 2 x USB sockets in the sleeping area on the driver's and passenger side (LHD), 1 x 230 V socket under the rear bed right in front of the storage space (and thus accessible from living area and rear storage space), 1 x USB socket / 1 x 230 V socket in bench seat.
- ²⁶⁾ Additional battery recommended.
- ²⁸⁾ Only in conjunction with 170 HP / 190 HP.
- ³²⁾ Malibu table and chair set option, consisting of two camping chairs including Malibu logo, carry bags and a table.
- ³⁴⁾ Speaker in driver's cab (2x) and lounge seating area (2x).
- ³⁵⁾ Malibu World of sleeping environments & décor set, consisting of: One or three decorative cushions (depending on model), a jacquard bed throw with woven Malibu logo and a fitted sheet set for the rear bed of the respective model. A fitted sheet set is not supplied for the optional cushion insert.
- ³⁶⁾ It is recommended to order the gas filter in conjunction with the Truma DuoControl CS option, since the manufacturer of the Truma DuoControl invalidates the warranty if the gas pressure regulator and valves become defective or damaged because of oil or other foreign materials in the liquid gas.
- ⁴⁹⁾ The wet wiper system provides the driver with improved vision, from the moment the wipers are turned on. The cleaning fluid is sprayed directly in front of the wiper blades and then immediately wiped away. This concentrated distribution significantly reduces the amount of cleaning fluid required.

- ⁵⁰⁾ The specification of the maximum permissible number of seats refers to the respective vehicle weight in a standard set-up without additional equipment, and specifies the maximum possible number of persons who can be seated while driving. The number of seats also depends on the weight and the axle load. It can therefore be reduced if additional equipment (equipment packages, special equipment) is installed, or it may only be achieved if the vehicle load is increased. Detailed information can be found on page 6, no.3.
- ⁵¹⁾ The maximum weight of additional equipment specified by the manufacturer must not be exceeded during the selection and configuration of your vehicle. The maximum weight for additional equipment specified by the manufacturer is intended to ensure that the legally prescribed so-called minimum payload is actually available for additional loading after the vehicle has been delivered by the manufacturer. This means that only a certain amount of additional equipment can be ordered and installed in the factory, in order to leave a sufficient weight allowance available for luggage and other accessories (the so-called payload) without exceeding the technically permissible gross vehicle weight. Detailed information can be found on page 6, no. 5.
- ⁵²⁾ The technically permissible gross vehicle weight describes the layout-based maximum permissible weight specified by the manufacturer that your motorhome is allowed to weigh when loaded (e.g. 3,500 kg, 4,100 kg). The technically permissible gross vehicle weight (e.g. 3,500 kg) must not be exceeded under any circumstances while driving. Detailed information can be found on page 4, no. 1.
- ⁵³⁾ The window cannot be opened due to the sliding door.
- ⁵⁴⁾ Bearing load 120 kg. Total towing weight for permissible gross vehicle weight of:
 3500 kg = 5500 kg / remaining towing capacity 2,000 kg
 4100 kg = 6,100 kg / remaining towing capacity 2,000 kg
 Tow bar only in conjunction with frame extension.
- ⁵⁵⁾ Isofix option includes additional cushion for use according to regulations.
- ⁵⁶⁾ Only available for bicycles with removable pedals.
- ⁵⁷⁾ Only in conjunction with 190 HP engine, automatic transmission, 93-litre tank, automatic air conditioning, 4,100 kg load increase and steel rims with all-terrain tyres.
- ⁵⁸⁾ Only in conjunction with basic pull-out rails in rear garage. Option includes extension rails.
- ⁶¹⁾ Only in conjunction with four-wheel drive, 190 HP, automatic transmission, 93-litre tank, automatic air conditioning and 4,100 kg load increase.
- ⁶²⁾ Only in conjunction with removable tow bar. Includes two carrier rails. Total bearing load 66 kg.
- ⁶⁴⁾ Recommended for retrofitting of bicycle and organisation system.
- ⁶⁵⁾ Multimedia system (Mercedes-Benz: MBUX 10.2" display; Fiat: 10.1" display), Bluetooth connectivity with audio streaming and hands-free function, smartphone integration via Android Auto or Apple CarPlay, USB interface for connecting portable devices. Mercedes-Benz: vehicle weights and vehicle dimensions cannot be stored separately in the navigation system.
- ⁶⁷⁾ replaces 90 Ah lithium-ion battery from standard equipment



More information
about the various
tyre designations
can be found here

Discover our Malibu vans
on our social media channels:



More information about Malibu can be found at
www.malibu-carthago.com

© Malibu GmbH & Co. KG | Carthago Ring 1 | 88326 Aulendorf | Germany

Tel. +49 (0)7525 / 9200-0

When this price list is published, all previous price lists lose their validity. Changes may occur during the model year after the editorial deadline for this printed document in July 2025. The manufacturer reserves the right to make structural and design changes that become necessary, provided that they are in the interest of technical progress and are reasonable for the customer, plus changes to equipment, differences in colour combinations or individual colour shades, material quality differences and changes to the scope of delivery on the part of the manufacturer. This also applies to colour differences on the chassis, insofar as they are a result of changes made by the chassis manufacturer. Please consult your dealer for detailed advice concerning the status of the current product or series.

The information relating to the scope of delivery, appearance, performance, dimensions and weights of the vehicles (differences within the scope of the factory tolerances (+/- 5% max.) are possible and permissible) corresponds to the available knowledge at the time of going to print. Reprinting of this document, or even extracts thereof, is only permitted if written authorisation is obtained from Malibu GmbH & Co. KG beforehand. The information in this publication is compliant with the German StVO and StVZO (road traffic and road traffic licensing regulations). Mistakes, printing errors and translation errors excepted. All information is based on the characteristics of the German market.

All prices listed in this price list are non-binding recommended retail prices (RRP) and include the statutory VAT applicable in the country of delivery, but exclude shipping and transport costs. Final pricing is at the sole discretion of the individual dealer. For this reason, please contact your dealer in advance. The prices stated in this price list do not constitute a binding offer. Subject to changes and errors.

0825 / V1



malibu
a company of carthago